



Cobham Road, Fetcham, Leatherhead, KT22 9JQ

£1,375 PCM





- AVAILABLE 1ST OCTOBER
- TWO BEDROOM MAISONETTE
- CENTRE OF FETCHAM VILLAGE
- OUTSIDE SPACE
- WHITE BATHROOM SUITE
- UNFURNISHED
- LOCATED ABOVE RETAIL PREMISES
- ELECTRIC STORAGE HEATING
- MODERN FITTED KITCHEN
- ALLOCATED PARKING SPACE

## Description

Two double bedroom maisonette situated above retail premises and located in the centre of Fetcham Village. Property comprises well appointed living room, modern fitted kitchen, family bathroom, outside terrace and allocated parking space.

## Situation

Fetcham Village shops offer a good variety of outlets including a Sainsburys Local. Leatherhead town offers a more comprehensive range of shopping facilities including the Swan Shopping Centre, theatre, Waitrose in Church Street and Nuffield Health Fitness Gym in The Crescent. The public leisure centre is located on the edge of the town at Fetcham Grove.

Cobham and Leatherhead main line railway stations offer excellent services to Waterloo, Victoria and London Bridge. Junction 9 of the M25 can be found on the Ashted side of Leatherhead. Gatwick and Heathrow Airports are within easy reach.

The area generally abounds in a wealth of glorious open unspoilt countryside with National Trust and Green Belt land close at hand. Bocketts Farm, Polesden Lacey and Norbury Park offer great family days out.

<b>EPC</b>	E
<b>Council Tax Band</b>	B



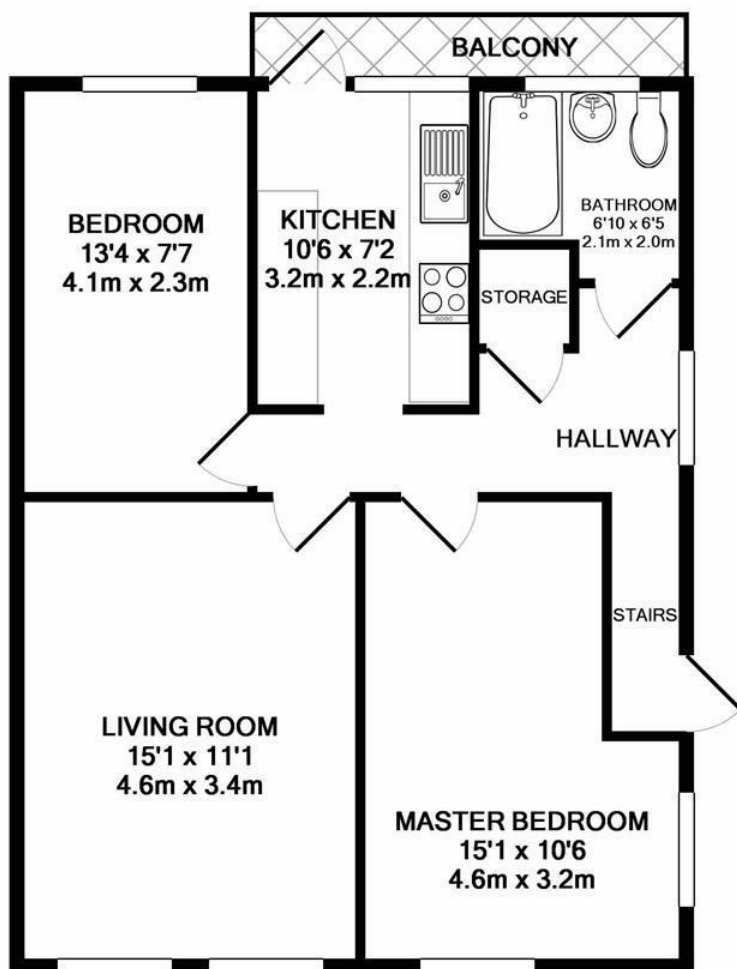

TOTAL APPROX. FLOOR AREA 613 SQ.FT. (57.0 SQ.M.)

Whilst every attempt has been made to ensure the accuracy of the floor plan contained here, measurements of doors, windows, rooms and any other items are approximate and no responsibility is taken for any error, omission, or mis-statement. This plan is for illustrative purposes only and should be used as such by any prospective purchaser. The services, systems and appliances shown have not been tested and no guarantee as to their operability or efficiency can be given  
Made with Metropix ©2019

## INFORMATION FOR TENANTS

### Holding Deposit

We require one weeks' rental, payable by bank transfer as a holding deposit to secure a property. Once we have received your holding deposit, current legislation stipulates that the necessary paperwork should be completed by all parties within 15 days or such longer period as might be agreed.

### Should your offer be agreed and you decide to proceed with a tenancy we require:

A refundable holding deposit of one weeks' rent at the beginning of negotiations. This amount will be deducted from your first months' rent prior to the commencement of the tenancy. Please be aware that should you withdraw from the negotiations, or be unable to provide suitable references this amount is **non-refundable**. Please further note that until this initial amount is paid the property may continue to be offered for rental.

### References

We use the referencing company, Lettings in a Box. The most straightforward way to complete the reference form is via an online link that your Lettings Negotiator will send by e-mail.

### Rent

Rent will be paid monthly in advance by bankers' standing order set up to leave your account 3 days before the rent due date in order to allow funds to clear.

### Deposit

A deposit of five weeks rental is held during the tenancy against damage and dilapidation Patrick Gardner & Co. are members of the Tenancy Deposit Scheme to safeguard your deposit.

### Inventory and schedule of condition

A professional inventory clerk will check you into the property at the beginning of the tenancy. The charge for this is borne by the Landlord.

These particulars, whilst believed to be accurate are set out as a general outline only for guidance and do not constitute any part of an offer or contract. Intending purchasers should not rely on them as statements of representation of fact, but must satisfy themselves by inspection or otherwise as to their accuracy. No person in this firm's employment has the authority to make or give any representation or warranty in respect of the property.